

***NIMBY Psychology:
What Can a Planner Do?***

Wendy Sarkissian PhD LFPIA

3 September 2013



NIMBY

Not In My Back Yard

Terminology





NIMBY Terminology

- **Rarely** defined same way by different researchers
- **Often**: catchall term to label opposition
- **Sometimes**: implies citizens have illegitimate or irrational selfish reasons for opposing facilities

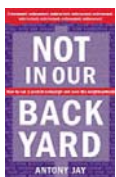

Proud to be a NIMBY

... any citizen, who tries to defend their home & their neighbourhood from plans which would destroy view, pollute environment, overload transport network, upset ecosystem & knock £50,000 off value of their house. When it comes to our own back yard, we are all nimbys, every nimby deserves respect for standing up to corporate & government giants.



Additional Terms

NIMTOO: Not in My Term Of Office

CAVE: Citizens Against Virtually Everything

BANANA: Build Absolutely Nothing Anywhere Near Anyone

NIABY: Not in Anyone's Back Yard

NOPE: Not On Planet Earth

My New Term

WATBY

What About Their Back Yard?

Explanations for ***NIMBY*** Opposition



Ignorance?

The public are not information-poor: they can capitalize upon a range of cultural & experiential resources.

Petts, J. (1997). Public-expert interface in local waste management decisions: expertise, credibility and process. *Public Understanding of Science*, 6(4), 359–381.



Selfishness?

Motivations for Opposing Developments

- **fairness**
- **sympathy**
- **commitment**
- **citizen duty**
- **morality**
- **beliefs**

Reasons for Opposing Developments

- lack trust in government
- fear health consequences
- negative impacts on quality of life
- few benefits for local people

A Pejorative Term

- usually meant & understood to be pejorative
- NIMBYs are usually selfish individuals who place protection of individual interests above common good

Beyond Ignorance and Selfishness?

How to address NIMBY issues?

1. **more emphasis:** address concerns citizens actually express
2. **less emphasis:** assume those who oppose projects are part of an overarching NIMBY syndrome

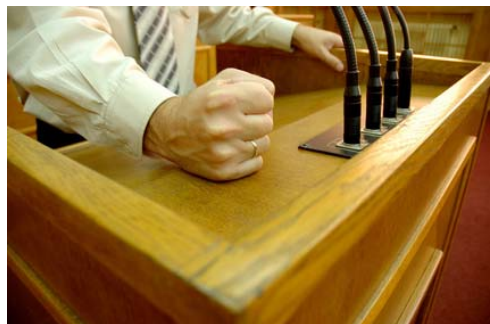

Does the current system promote so-called “NIMBYism”?



Place-Related Meanings
& Attachments



NIMBY Psychology



Environmental Psychology
Community Psychology
Humanistic Psychology
Environment-Behavior Studies



Place Attachment and Place-Protective Behaviour

- Environmental psychology
- The territorial core
- Housing messages
- The threshold
- Privacy: frontstage an backstage
- Identity, image and housing form
- Personalisation
- The house as mirror of the self

Territory

The Home is the Territorial Core



Home and territory are hard-wired.



Housing Messages



Privacy

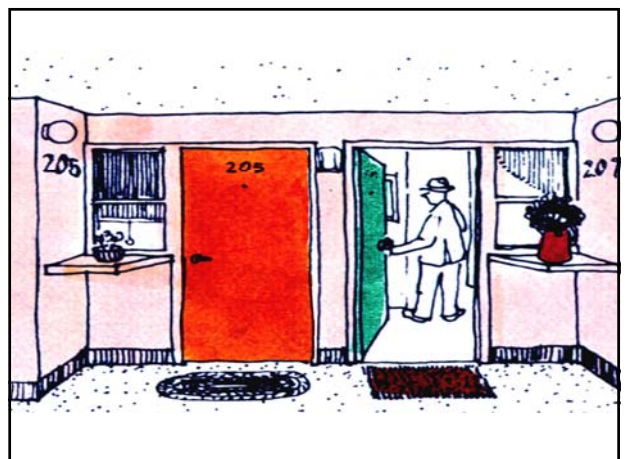

Frontstage & Backstage

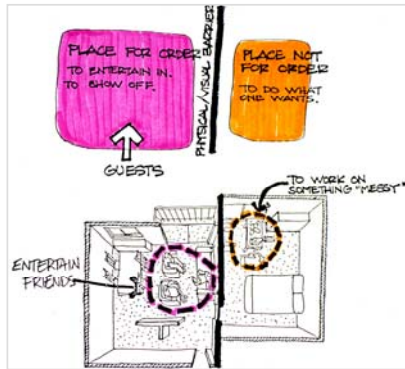

Identity, image and housing form

The House as a Mirror of Self

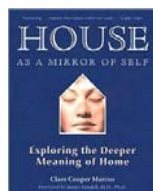

Professor Emerita Clare Cooper Marcus

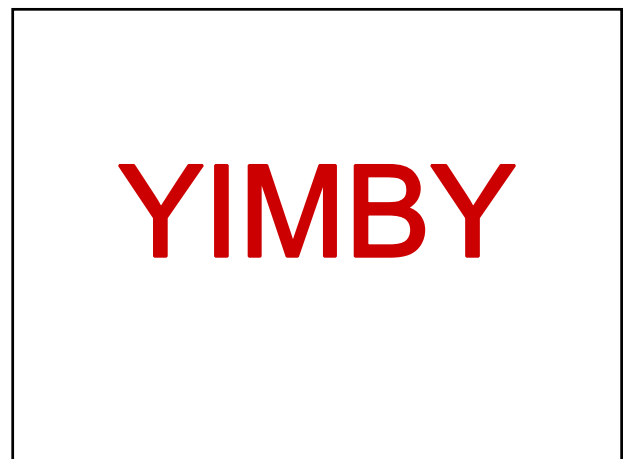
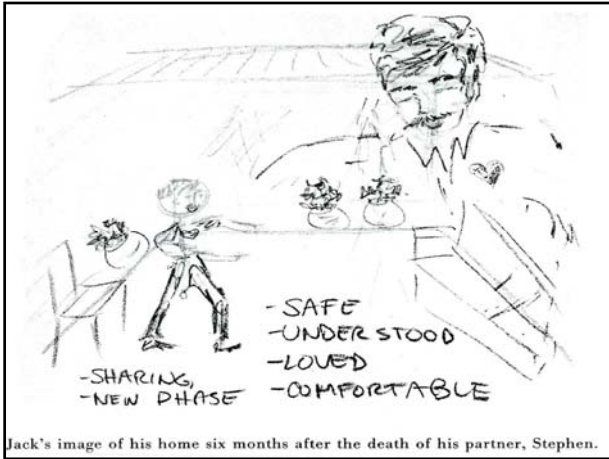

Community Engagement Approaches that Might Work



Prof. Patrick Devine-Wright
Dept. of Geography, Life & Environmental
Sciences, University of Exeter

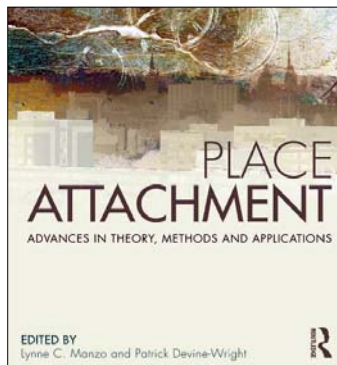

No Single
One-Size-Fits-All
Approach



New Models of Community Engagement

Key Attributes of Engagement

1. Public Participation
2. Inclusion
3. Deliberation

1. Public Participation

1. Agenda setting
2. Decision making
3. Policy-forming activities



1. *Public Participation*

Mechanisms:

- Planning workshops
- Consensus conferences
- Task forces
- Citizens' panels
- Focus groups
- Stakeholder dialogues
- Town meetings

2. Inclusion

- Substantially engage variety of community voices
- Tolerate diverse views
- Include views of those often neglected or hard-to-reach

3. Deliberation

Public will:

- Consume & process information about proposed development & impacts
- Engage with issues considered in proposal
- Provide reasoned arguments for preferences about development

A New Conceptual Framework for Understanding Public Engagement

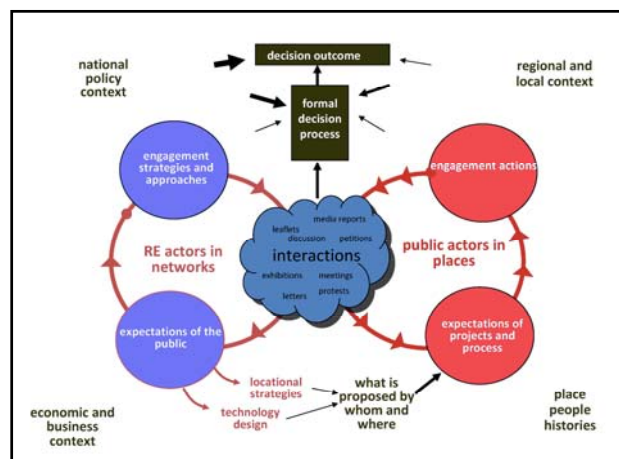

So...
How to engage with so-called
NIMBY responses?

Housing density increases
in suburban Minneapolis

How to address NIMBY issues?

1. **More emphasis:** address concerns
citizens actually express

How to address NIMBY issues?

1. **More emphasis:** address concerns
citizens actually express
2. **Less emphasis:** assume those who
oppose projects are part of
overarching NIMBY syndrome

Case Study
Minnesota Block Exercise

Corridor Development Initiative Minnesota Block Exercise



The Corridor Housing Initiative Block Exercise How-To Guide

Metropolitan Design Center
June 2006

METROPOLITAN College of Design University of Minnesota
141 E. 15th St. Minneapolis, MN 55455

3-Stage Process

1. Preliminary workshops
2. Minnesota Block Exercise:
hands-on
3. Materials for Developers

Extra-statutory community
capacity-strengthening process

Regular statutory controls and mandated
engagement processes still apply.

Stage 1 Preliminary workshops



Stage 2 What it looks like on the Day



Examples from 8 November 2006
Mayor R.T. Rybak



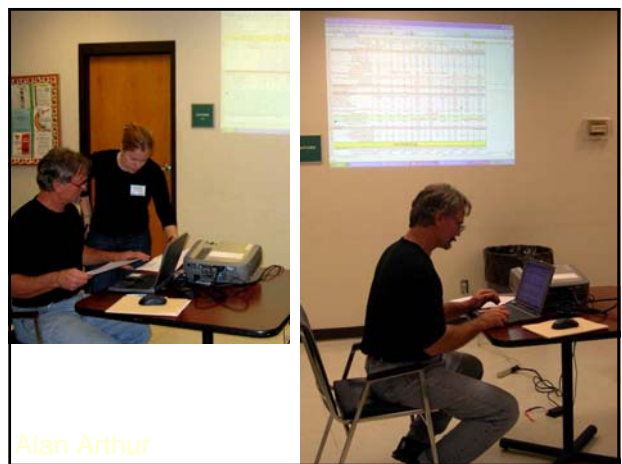
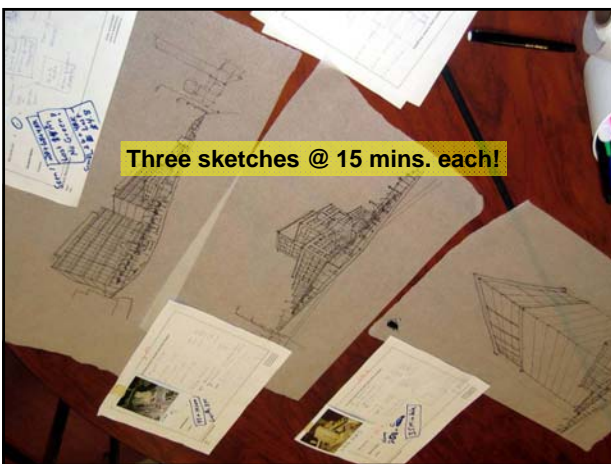



Stage 3
Material Developed
from this
and Subsequent Workshops

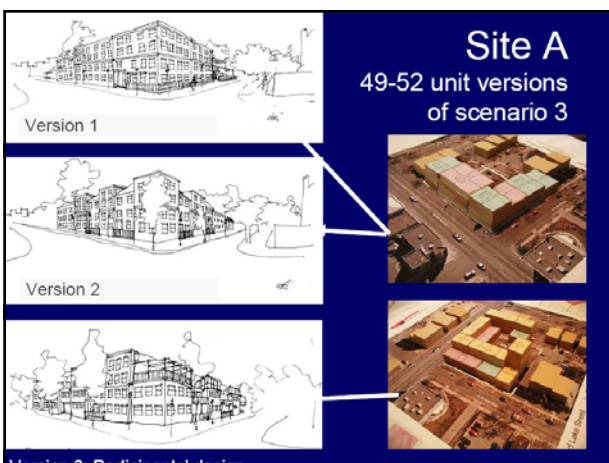

Minnesota Block Exercise
Website

www.housinginitiative.org



wendy@sarkissian.com.au

www.sarkissian.com.au